

**Modular Cooking Range Line**  
**thermaline 80 - 500 mm Freestanding**  
**Electric Free-cooking Top, Smooth Plate,**  
**1 Side, H=700**

ITEM # \_\_\_\_\_  
 MODEL # \_\_\_\_\_  
 NAME # \_\_\_\_\_  
 SIS # \_\_\_\_\_  
 AIA # \_\_\_\_\_



**588378 (MATDEAEDAO)**

Electric Free-Cooking Top,  
 one-side operated

### Short Form Specification

#### Item No.

Unit constructed according to DIN 18860\_2 with 20 mm drop nose top and 70 mm recessed plinth. Internal frame for heavy duty sturdiness in stainless steel. 2 mm top in 1.4301 (AISI 304). Flat surface construction, easily cleanable. THERMODUL connection system enables seamless worktop when units are connected and avoids soil penetrating. Smooth electrically-heated solid plate made of 20 mm thick steel with a wide rounded cleaning zone around the plate. Rapid plate heat up, continuously ready to use; maximum reachable surface temperature of 350°C. Overheat protection switches off the supply in case of overheating. Standby function saves energy and quickly recovers maximum power. Metal knobs with embedded hygienic silicon "soft" grip enable easier handling and cleaning. IPX5 water resistance certification. Configuration: Freestanding, one-side operated.

### Main Features

- For direct and indirect cooking.
- Rapid heat up of the plate and continuously ready for use.
- Overheat protection: a temperature sensor switches off the supply in case of overheating.
- Wide rounded cleaning zone around the plates for easier cleaning.
- All major components may be easily accessed from the front.
- THERMODUL connection system creates a seamless work top when units are connected to each other thus avoiding soil penetrating vital components and facilitating the removal of units in case of replacement or service.
- Metal knobs with embedded hygienic "soft-touch" grip for easier handling and cleaning. The special design of the controls prevents infiltration of liquids or soil into vital components.
- Large visible digital display manufactured in tempered glass to resist heat and chemicals, showing temperatures or power settings. The display also shows on/off status of the appliance and on/off status of the heating elements.
- Cooking plate and base joint profile guarantee against soil infiltration.
- Surface temperature up to 350°C

### Construction

- Unit constructed according to DIN 18860\_2 with 20 mm drop nose top and 70 mm recessed plinth.
- Flat surface construction with minimal hidden areas to easily clean all surfaces
- Cooking surface is an electrically heated solid plate made from 20 mm thick stainless steel AISI 316 - DIN 1.4404.
- IPX5 water resistance certification.
- 2mm thick top in stainless steel AISI 304 - DIN 1.4301.
- Internal frame for heavy duty sturdiness in stainless steel.

### Optional Accessories

- |                                                       |                                     |
|-------------------------------------------------------|-------------------------------------|
| • Connecting rail kit, 800mm                          | PNC 912500 <input type="checkbox"/> |
| • Stainless steel side panel, 800x700mm, freestanding | PNC 912509 <input type="checkbox"/> |
| • Portioning shelf, 500mm width                       | PNC 912523 <input type="checkbox"/> |
| • Portioning shelf, 500mm width                       | PNC 912553 <input type="checkbox"/> |
| • Folding shelf, 300x800mm                            | PNC 912577 <input type="checkbox"/> |
| • Folding shelf, 400x800mm                            | PNC 912578 <input type="checkbox"/> |
| • Fixed side shelf, 200x800mm                         | PNC 912583 <input type="checkbox"/> |
| • Fixed side shelf, 300x800mm                         | PNC 912584 <input type="checkbox"/> |

**APPROVAL:** \_\_\_\_\_

|                                                                                                                                                              |            |                          |                                           |            |                          |
|--------------------------------------------------------------------------------------------------------------------------------------------------------------|------------|--------------------------|-------------------------------------------|------------|--------------------------|
| • Fixed side shelf, 400x800mm                                                                                                                                | PNC 912585 | <input type="checkbox"/> | • C41 HI-TEMP RAPID DEGREASER, 1          | PNC 0S2292 | <input type="checkbox"/> |
| • Stainless steel front kicking strip, 500mm width                                                                                                           | PNC 912631 | <input type="checkbox"/> | pack of six 1 lt. bottles (trigger incl.) |            |                          |
| • Stainless steel side kicking strip left and right, freestanding, 800mm width                                                                               | PNC 912655 | <input type="checkbox"/> |                                           |            |                          |
| • Stainless steel side kicking strip left and right, back-to-back, 1610mm width                                                                              | PNC 912661 | <input type="checkbox"/> |                                           |            |                          |
| • Stainless steel plinth, freestanding, 500mm width                                                                                                          | PNC 912860 | <input type="checkbox"/> |                                           |            |                          |
| • Connecting rail kit: modular 80 (on the left) to ProThermatic tilting (on the right), ProThermatic stationary (on the left) to ProThermatic (on the right) | PNC 912971 | <input type="checkbox"/> |                                           |            |                          |
| • Connecting rail kit: modular 80 (on the right) to ProThermatic tilting (on the left), ProThermatic stationary (on the right) to ProThermatic (on the left) | PNC 912972 | <input type="checkbox"/> |                                           |            |                          |
| • Endrail kit, flush-fitting, left                                                                                                                           | PNC 913109 | <input type="checkbox"/> |                                           |            |                          |
| • Endrail kit, flush-fitting, right                                                                                                                          | PNC 913110 | <input type="checkbox"/> |                                           |            |                          |
| • Scraper for smooth plates                                                                                                                                  | PNC 913119 | <input type="checkbox"/> |                                           |            |                          |
| • Endrail kit (12.5mm) for thermaline 80 units, left                                                                                                         | PNC 913200 | <input type="checkbox"/> |                                           |            |                          |
| • Endrail kit (12.5mm) for thermaline 80 units, right                                                                                                        | PNC 913201 | <input type="checkbox"/> |                                           |            |                          |
| • Stainless steel side panel, left, H=700                                                                                                                    | PNC 913214 | <input type="checkbox"/> |                                           |            |                          |
| • Stainless steel side panel, right, H=700                                                                                                                   | PNC 913215 | <input type="checkbox"/> |                                           |            |                          |
| • T-connection rail for back-to-back installations without backsplash (to be ordered as S-code)                                                              | PNC 913227 | <input type="checkbox"/> |                                           |            |                          |
| • Insert profile D=800mm                                                                                                                                     | PNC 913230 | <input type="checkbox"/> |                                           |            |                          |
| • Perforated shelf for warming cabinets and cupboard bases (one-side operated TL80-85-90 and two-side operated for TL80)                                     | PNC 913233 | <input type="checkbox"/> |                                           |            |                          |
| • Energy optimizer kit 14A - factory fitted                                                                                                                  | PNC 913244 | <input type="checkbox"/> |                                           |            |                          |
| • Endrail kit, (12.5mm), for back-to-back installation, left                                                                                                 | PNC 913249 | <input type="checkbox"/> |                                           |            |                          |
| • Endrail kit, (12.5mm), for back-to-back installation, right                                                                                                | PNC 913250 | <input type="checkbox"/> |                                           |            |                          |
| • Endrail kit, flush-fitting, for back-to-back installation, left                                                                                            | PNC 913253 | <input type="checkbox"/> |                                           |            |                          |
| • Endrail kit, flush-fitting, for back-to-back installation, right                                                                                           | PNC 913254 | <input type="checkbox"/> |                                           |            |                          |
| • Side reinforced panel only in combination with side shelf, for freestanding units                                                                          | PNC 913258 | <input type="checkbox"/> |                                           |            |                          |
| • Side reinforced panel only in combination with side shelf, for back-to-back installations, left                                                            | PNC 913271 | <input type="checkbox"/> |                                           |            |                          |
| • Side reinforced panel only in combination with side shelf, for back-to-back installation, right                                                            | PNC 913272 | <input type="checkbox"/> |                                           |            |                          |
| • Shelf fixation for TL80-85-90 one-side operated, TL80 two-side operated                                                                                    | PNC 913279 | <input type="checkbox"/> |                                           |            |                          |
| • Filter W=500mm                                                                                                                                             | PNC 913664 | <input type="checkbox"/> |                                           |            |                          |

## Recommended Detergents



**Electrolux**  
PROFESSIONAL

**Modular Cooking Range Line**  
**thermaline 80 - 500 mm Freestanding Electric**  
**Free-cooking Top, Smooth Plate, 1 Side, H=700**

Front

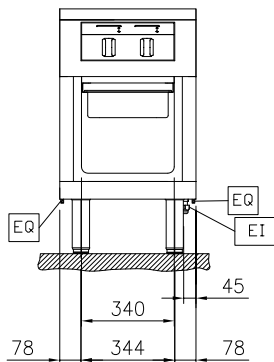

Side

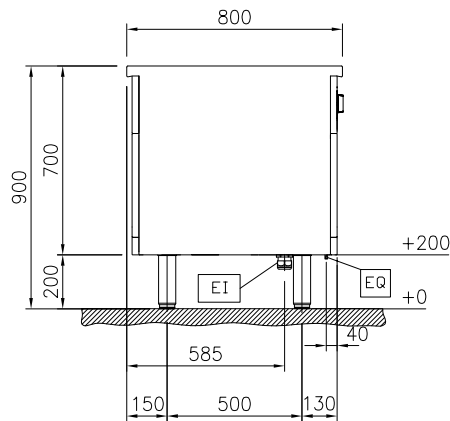

EI = Electrical inlet (power)  
EQ = Equipotential screw

Top

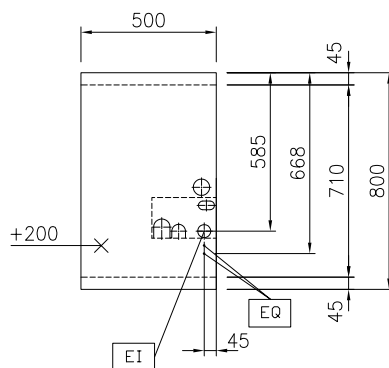

**Electric**

Supply voltage: 400 V/3N ph/50/60 Hz  
Total Watts: 6 kW

**Key Information:**

Working Temperature MIN: 80 °C  
Working Temperature MAX: 350 °C  
External dimensions, Width: 500 mm  
External dimensions, Depth: 800 mm  
External dimensions, Height: 700 mm  
Net weight: 100 kg

Configuration: On Base; One-Side Operated

**Sustainability**

Current consumption: 13 Amps



**Modular Cooking Range Line**  
**thermaline 80 - 500 mm Freestanding Electric Free-cooking Top,**  
**Smooth Plate, 1 Side, H=700**  
The company reserves the right to make modifications to the products  
without prior notice. All information correct at time of printing.

2025.06.02

### Optional Accessories

|                                                                                                                                                              |            |                          |
|--------------------------------------------------------------------------------------------------------------------------------------------------------------|------------|--------------------------|
| • Connecting rail kit, 800mm                                                                                                                                 | PNC 912500 | <input type="checkbox"/> |
| • Stainless steel side panel, 800x700mm, freestanding                                                                                                        | PNC 912509 | <input type="checkbox"/> |
| • Portioning shelf, 500mm width                                                                                                                              | PNC 912523 | <input type="checkbox"/> |
| • Portioning shelf, 500mm width                                                                                                                              | PNC 912553 | <input type="checkbox"/> |
| • Folding shelf, 300x800mm                                                                                                                                   | PNC 912577 | <input type="checkbox"/> |
| • Folding shelf, 400x800mm                                                                                                                                   | PNC 912578 | <input type="checkbox"/> |
| • Fixed side shelf, 200x800mm                                                                                                                                | PNC 912583 | <input type="checkbox"/> |
| • Fixed side shelf, 300x800mm                                                                                                                                | PNC 912584 | <input type="checkbox"/> |
| • Fixed side shelf, 400x800mm                                                                                                                                | PNC 912585 | <input type="checkbox"/> |
| • Stainless steel front kicking strip, 500mm width                                                                                                           | PNC 912631 | <input type="checkbox"/> |
| • Stainless steel side kicking strip left and right, freestanding, 800mm width                                                                               | PNC 912655 | <input type="checkbox"/> |
| • Stainless steel side kicking strip left and right, back-to-back, 1610mm width                                                                              | PNC 912661 | <input type="checkbox"/> |
| • Stainless steel plinth, freestanding, 500mm width                                                                                                          | PNC 912860 | <input type="checkbox"/> |
| • Connecting rail kit: modular 80 (on the left) to ProThermetic tilting (on the right), ProThermetic stationary (on the left) to ProThermetic (on the right) | PNC 912971 | <input type="checkbox"/> |
| • Connecting rail kit: modular 80 (on the right) to ProThermetic tilting (on the left), ProThermetic stationary (on the right) to ProThermetic (on the left) | PNC 912972 | <input type="checkbox"/> |
| • Endrail kit, flush-fitting, left                                                                                                                           | PNC 913109 | <input type="checkbox"/> |
| • Endrail kit, flush-fitting, right                                                                                                                          | PNC 913110 | <input type="checkbox"/> |
| • Scraper for smooth plates                                                                                                                                  | PNC 913119 | <input type="checkbox"/> |
| • Endrail kit (12.5mm) for thermaline 80 units, left                                                                                                         | PNC 913200 | <input type="checkbox"/> |
| • Endrail kit (12.5mm) for thermaline 80 units, right                                                                                                        | PNC 913201 | <input type="checkbox"/> |
| • Stainless steel side panel, left, H=700                                                                                                                    | PNC 913214 | <input type="checkbox"/> |
| • Stainless steel side panel, right, H=700                                                                                                                   | PNC 913215 | <input type="checkbox"/> |
| • T-connection rail for back-to-back installations without backsplash (to be ordered as S-code)                                                              | PNC 913227 | <input type="checkbox"/> |
| • Insert profile D=800mm                                                                                                                                     | PNC 913230 | <input type="checkbox"/> |
| • Perforated shelf for warming cabinets and cupboard bases (one-side operated TL80-85-90 and two-side operated for TL80)                                     | PNC 913233 | <input type="checkbox"/> |
| • Energy optimizer kit 14A - factory fitted                                                                                                                  | PNC 913244 | <input type="checkbox"/> |
| • Endrail kit, (12.5mm), for back-to-back installation, left                                                                                                 | PNC 913249 | <input type="checkbox"/> |
| • Endrail kit, (12.5mm), for back-to-back installation, right                                                                                                | PNC 913250 | <input type="checkbox"/> |
| • Endrail kit, flush-fitting, for back-to-back installation, left                                                                                            | PNC 913253 | <input type="checkbox"/> |
| • Endrail kit, flush-fitting, for back-to-back installation, right                                                                                           | PNC 913254 | <input type="checkbox"/> |
| • Side reinforced panel only in combination with side shelf, for freestanding units                                                                          | PNC 913258 | <input type="checkbox"/> |

|                                                                                                   |            |                          |
|---------------------------------------------------------------------------------------------------|------------|--------------------------|
| • Side reinforced panel only in combination with side shelf, for back-to-back installations, left | PNC 913271 | <input type="checkbox"/> |
| • Side reinforced panel only in combination with side shelf, for back-to-back installation, right | PNC 913272 | <input type="checkbox"/> |
| • Shelf fixation for TL80-85-90 one-side operated, TL80 two-side operated                         | PNC 913279 | <input type="checkbox"/> |
| • Filter W=500mm                                                                                  | PNC 913664 | <input type="checkbox"/> |
| <b>Recommended Detergents</b>                                                                     |            |                          |
| • C41 HI-TEMP RAPID DEGREASER, 1 pack of six 1 lt. bottles (trigger incl.)                        | PNC 0S2292 | <input type="checkbox"/> |